

PlateRite HD 8900Z/S/E

Thermal Plate Recorder



Creating a Future in Print

New flagship 8-Page Model Delivers Throughput of over 65 Plates per Hour!

PlateRite HD 8900Z/S/E

Made-in-Japan reliability from the world leader in CtP technology

Speed

High-speed output of over 65 plates per hour

The high-end PlateRite HD 8900Z*¹ features a 1,024-channel imaging head that utilizes GLV™ technology. This enables output of more than 65 plates per hour,*² allowing a single PlateRite HD 8900Z to replace multiple CtP recorders in an existing line. Processing is easier to manage and running costs and liquid waste are lower than ever.

The PlateRite HD 8900Z delivers the almost instantaneous response required for today's small lots and ultra-short deadlines, providing a new level of added value for clients. The S and E models also feature a 512-channel imaging head, with respective throughputs of up to 43 and 33 plates per hour.

*¹ The Z model is scheduled for release in 3Q 2011 CY.

*² At 2,400 dpi, with 1,030 x 800 mm (40.5" x 31.5") plates.

Variety of plate sizes for different presses

The PlateRite HD 8900 series supports plates ranging from 304 x 305 mm (12.0" x 12.1") to 1,165 x 950 mm (45.8" x 37.4"). Compatibility with 6-mm leading and tailing edge clamps also enables output from a wider variety of presses. Simplified plate setting further improves operating ratios, boosting the productivity delivered by the series' high-speed output.

Quality

Creation of sharper halftone dots with the latest technology

In addition to its GLV-equipped imaging head, the PlateRite HD 8900 series uses screening options ranging from Screen's unique Spekta and Spekta 2 AM/FM hybrid screening through to high-end AM and FM screening. The result is superior image quality suitable for a variety of applications at a standard 2,400 dpi resolution. Imaging quality is also more reliable thanks to an auto-focus function.

High-resolution output of 4,000 dpi

The S and E models offer a 4,000 dpi high-resolution option* that uses ultra-precise AM halftone dots. This option supports the creation of plates for extremely detailed output, including high-resolution art printing and accurate reproduction of the small text sizes required for bond and other certificate printing.

* Available as an option for the S and E models.

* Under development.

Compatibility with lenticular output mode

Lenticular output mode,* which performs step exposure ideal for lenticular production, will soon be available as an option. This mode eliminates the interference moire seen with lenticular lenses and is optimal for the imaging of high-precision straight lines, such as those in bar codes. Installation of the 4,000 dpi option also enables the output of high-resolution plates for 3D lenticular printing.

* Available as an option for the S and E models.

* Under development.

Speed

Efficient production with super-fast output

Over 65 plates* per hour

* Z model

Quality

Remarkable quality

Max. resolution of 4,000 dpi*

* Option for S and E models.

Automation

Improved operability

Autoloading system

Ecology

Safe for employees, gentle on environment

Environmentally conscious CtP

Automation

Autoloader maximizes productivity



Newly designed!

An autoloader system can be installed to automate the entire platemaking process, from plate loading through imaging and transport to developing. The autoloader enables extended periods of continuous operation and significantly increases both productivity and press operating ratios.

Loading of plates during processing

The MA-L8900 allows plates to be loaded into the cassette during continuous operation. This avoids downtime when additional plates are required and maximizes productivity and press operating ratios.



The ergonomic design ensures easy operation even when adding plates to cassettes.

MA-L8900 multi-cassette autoloader

The MA-L8900 comes standard with three plate cassettes (up to five as an option) and full automation of both plate supply and cassette

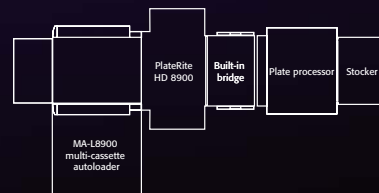

switching. Each cassette holds up to 100 plates,* for a maximum of 500 plates stored in the autoloader. Even if different plate sizes are loaded into separate cassettes, the autoloader flexibly switches between the cassettes as required. Loading all cassettes with the same plate size enables extended periods of continuous operation.

* For 0.3mm plates

SA-L8900 single cassette autoloader

The SA-L8900 features a single cassette that holds up to 100 plates* as well as automatic detection

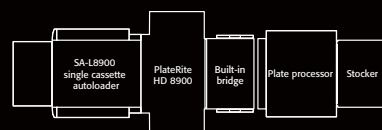

and removal of interleaf paper. Its transport system only contacts the rear side of a plate, preventing damage to the sensitive emulsion side. Manual loading is also possible, giving operators the flexibility to select plate sizes as required.

* For 0.3mm plates



Remote status checking at any time

- Remote monitoring system

CtP operating conditions and output history can easily be checked from a remote location via Web browser or e-mail. E-mails can also be automatically forwarded to a service center and entered into a database for use in maintenance, repairs, and periodic inspections. This ensures the recorder remains in optimal condition at all times (support contract required).

- Remote control system*

An external PC can effectively be used as a substitute operation panel, allowing users at remote locations to make CtP settings and send commands. This gives operators greater flexibility and also allows technicians at remote service centers to perform maintenance.

* Under development.

Ecology

Gentle on the environment

Screen assesses the environmental impact of all its products as a form of design review. The PlateRite HD 8900 series has been developed with the goals of minimizing energy use and environmental impact while maximizing safety.

- Energy use during operation has been cut by up to 9%.*
- A new power-saving mode allows energy savings of around 65% during idling.
- The low-impact design conforms to RoHS environmental standards.
- All models are compatible with chemical-less plates from a range of manufacturers.

* Comparison of the PlateRite HD 8900S and PlateRite 8600S. This value is for when a multi-cassette autoloader is connected. It may vary depending on the installation environment and does not represent a guaranteed level of energy saving.



PlateRite HD 8900Z/S/E specifications

Product Name	PlateRite HD 8900Z	PlateRite HD 8900S	PlateRite HD 8900E
Model Name	PT-R8900		
Recording system	External drum		
Light source	1,024-channel laser diode	512-channel laser diode	
Plate size	Maximum: 1,165 x 950 mm (45.8" x 37.4"); Minimum: 304 x 305 mm (12.0" x 12.1")* ¹		
Exposure size	Maximum: 1,165 x 938 mm (45.8" x 36.9")		
Plate	Thermal aluminum plate		
Plate thickness	0.15 to 0.3 mm (5.9 mil to 11.8 mil) [0.4 mm (15.7 mil)* ² available as an option]		
Resolutions	1,200* ³ /2,400/2,438/2,540 dpi	1,200* ³ /2,400/2,438/2,540/4,000 dpi (4,000 dpi is only available when the high resolution option* ⁴ is selected)	
Repeatability	±5 μm* ⁵		
Productivity * ⁶	Over 65 plates/hr at 2,400 dpi (1,030 x 800 mm/40.5" x 31.4" plates)	43 plates/hr at 2,400 dpi (1,030 x 800 mm/40.5" x 31.4" plates)	33 plates/hr at 2,400 dpi (1,030 x 800 mm/40.5" x 31.4" plates)
Interface	S-PIF		
Punch systems	Screen, Heidel, Heidelberg W, Protocol, and Komori punch systems are standard; all others are special orders. (Up to twelve individual punch blocks can be selected and mounted as an option, depending on the plate sizes and printing press types being used.)		
Dimensions (W x D x H)	Main unit: 2,640 x 1,475 x 1,394 mm (104" x 58.1" x 54.9")(blower unit is internal) Chiller unit: 350 x 720 x 720 mm (13.8" x 28.4" x 28.4")		
Weight	Main unit: 1,115 kg (2,530 lb); Chiller unit: 63 kg (138.6 lb)		
Power requirements	Main unit: Single phase 200 V to 240 V, 16 A, 3.2 kW Chiller unit: Single phase 200 V to 240 V, 4 A, 0.7 kW [SA-L and MA-L are supplied by main unit.]	Main unit: Single phase 200 V to 240 V, 16 A, 3.2 kW Chiller unit* ⁷ : Single phase 200 V to 240 V, 3 A, 0.6 kW [SA-L and MA-L are supplied by main unit.]	
Environment	Recommended: 21 to 25°C (69.8 to 77°F); Required: 18 to 26°C (64.4 to 78.8°F); Relative humidity: 40 to 70% (no condensation)		
Required options * ⁸	MA-L8900, SA-L8900, plate insertion table		
Options	Plate transport system to connect with plate processor (built-in bridge, AT-T8001R, AT-M8001), various printing press punches, support for 0.4 mm (15.7 mil) thickness, high resolution (4,000 dpi support)* ⁴ , lenticular printing plate output* ⁴ , air filter unit (AF-180N), upgrade to Z or S specifications.		
Applicable standard	Main unit: Approved UL, CSA, Declared CE Chiller unit: Approved UL, CSA, Declared CE		

*¹ Plates wider than 590 mm (23.3") and narrower than 610 mm (24") cannot be used. *² Plates that are 0.4 mm (15.7 mil) thick must be 900 x 770 mm (35.5" x 30.4") or larger.

*³ 1,200 dpi uses 2,400 dpi double dots. *⁴ Option must be selected before the unit is shipped from the factory. *⁵ Over four consecutive exposures on one plate at 23°C (73.4°F) and 60% relative humidity.

*⁶ This value is for when an autoloader is connected. Productivity may vary depending on the sensitivity of the plate. *⁷ The North American specifications may be single phase 200/208/220/230/240 V, 8 A, 1.4 kW.

*⁸ One of the options must be selected. Consult a Screen representative regarding throughput when the plate insertion table is chosen.

Autoloader specifications

Product Name	SA-L8900	MA-L8900
Compatible models* ¹	PlateRite 8900Z/S/E	
No. of cassettes	1	Up to 5 cassettes (3 cassettes as standard)
Cassette capacity	100 plates (0.15 to 0.3 mm thickness) 75 plates (More than 0.3 mm thickness)	100 plates per cassette (0.15 to 0.3 mm thickness) 75 plates per cassette (More than 0.3 mm thickness)
Plate size	Maximum: 1,165 x 950 mm (45.8" x 37.4"); Minimum: 304 x 305 mm (12.0" x 12.1")	
Plate thickness	0.15 to 0.4 mm (5.9 mil to 15.7 mil)	
Dimensions (W x D x H)	1,827 x 2,351 x 1,530 mm (72.0" x 92.6" x 61.3")	3,345 x 2,351 x 1,530 mm (131.7" x 92.6" x 61.3")
Weight* ²	600 kg (1,320 lb)	1,088kg (2,394lb)
Power requirements	Supplied by main unit	
Environment	Recommended: 21 to 25°C (69.8 to 77°F); Required: 18 to 26°C (64.4 to 78.8°F); Relative humidity: 40 to 70% (no condensation)	
Options	Additional carrier-type cassette (with dustproof cover) Left layout kit (for filed upgrade is under consideration)	Additional cassette Left layout as factory option

*¹. PlateRite 8000N series can not be connected. *². Not including the weight of the plates.

Dimensions

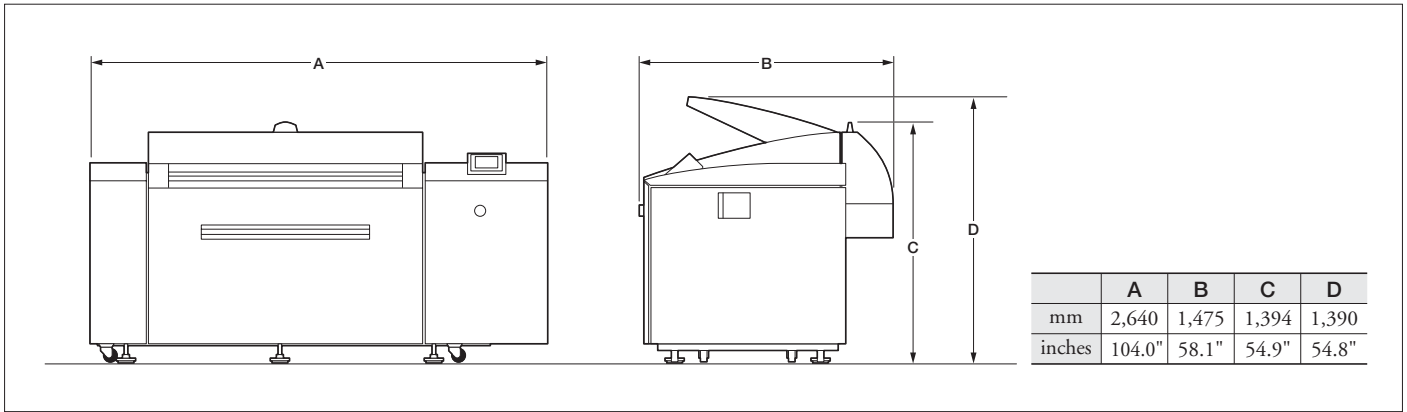

Floor plan

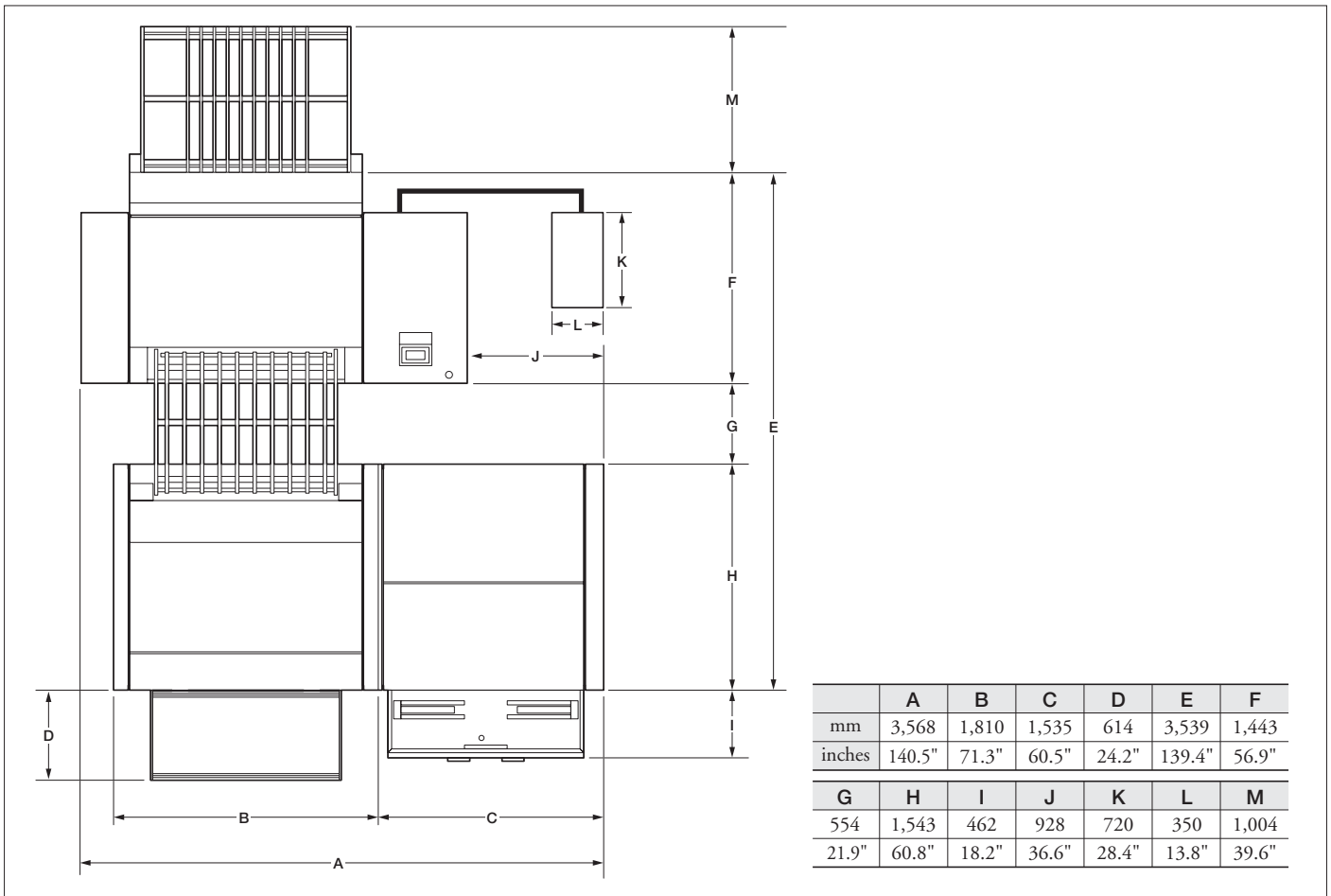

DAINIPPON SCREEN MFG. CO., LTD.

HEAD OFFICE
 • Ipiranouchi-agaru, 4-chome, Horikawa-dori, Kamigyo-ku, Kyoto, 602-8585 Japan/Phone +81-75-414-7610/Fax +81-75-414-7608

DAINIPPON SCREEN GRAPHICS (USA), LLC
 • 5110 Tollview Dr., Rolling Meadows, IL 60008, USA/Phone +1-847-870-7400/Fax +1-847-870-0149 www.screenusa.com

DAINIPPON SCREEN (DEUTSCHLAND) GmbH
 • Mündelheimer Weg 39, 40472 Düsseldorf, Germany/Phone +49-211-472701/Fax +49-211-4727199

DAINIPPON SCREEN (U.K.) LTD.
 • Michigan Drive, Thongwell, Milton Keynes, Buckinghamshire MK15 8HT, UK/Phone +44-1908-848500/Fax +44-1908-848501 www.screen.co.uk

DAINIPPON SCREEN (NEDERLAND) B.V.
 • Bouwerij 46, 1185 XX Amstelveen, Holland/Phone +31-20-4567800/Fax +31-20-4567805 www.screeneuropa.com

DAINIPPON SCREEN SINGAPORE PTE. LTD.
 • 29, Kaki Bukit View, Kaki Bukit Technopark II, Singapore 415963/Phone +65-6749-3833/Fax +65-6749-9010 www.screensp.com.sg

DAINIPPON SCREEN (CHINA) LTD.
 • Room 2001 - 2003, 20/F Cable TV Tower 9 Hoi Shing Road Tsuen Wan, N.T. Hong Kong/Phone +852-2953-0038/Fax +852-2755-8683

Beijing office/Phone +86-10-6708-9271, 9272, 9273/Fax +86-10-6708-9395
Shanghai office/Phone +86-21-3126-5122/Fax +86-21-5219-2199
Guangzhou office/Phone +86-20-3891-1112/Fax +86-20-3891-1036

DAINIPPON SCREEN (TAIWAN) CO., LTD.
 • 4F No. 126-1, Ming Tsu West Rd., Taipei, Taiwan/Phone +886-2-25862711/Fax +886-2-25914367

DAINIPPON SCREEN (KOREA) CO., LTD.
 • 10th Yonsel Bongaek B/D 48-3, 1Ga, Bongaek-Dong, Joong-Gu, Seoul 100-161, Korea/Phone +82-2-7766-786/Fax +82-2-7766-787

DAINIPPON SCREEN (AUSTRALIA) PTY. LTD.
 • Suite 11, 2 Eden, Park Drive, Macquarie, NSW2133, Australia/Phone +61-2-9016-3400/Fax +61-2-9016-3425

• This brochure was made using SPEKTA 2 screening.

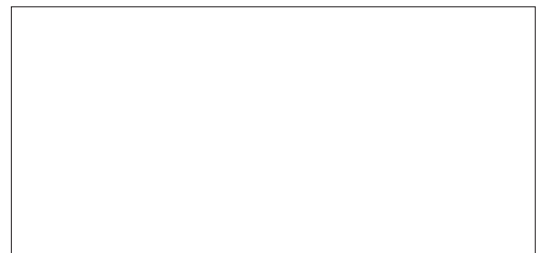

We reserve the right to alter product design and specifications without prior notice.

Internet web site : www.screen.co.jp
www.screenusa.com
www.screeneuropa.com